

### SpeedTech Lights

Phone Number: 800-757-2581  
 Fax Numbers: 866-661-2025 , 512-295-0364  
 Company Address: 218 Trademark Dr, Buda, TX 78610



**K-700**



**K-900**

**Available Colors**  
 B: BLUE  
 R: RED  
 A: AMBER  
 C: CLEAR

**IMPORTANT:** Please read all of the following instructions before installing your new **Flare™** series Hide-A-Way LED.

**WARNING!!!!** Failure to install or use this product according to manufacturer's recommendations may result in property damage, and/or serious injury!

- \*Proper installation of this product requires the installer to have a good understanding of automotive electronics, systems and procedures.
- \*This product contains high-intensity LEDs. Do not stare directly into these lights. Momentary blindness and/or eye damage could result.
- \*Use only soap and water to clean the outer lens.
- \*Do not install this product or route any wires in the deployment area of your air bag. Equipment mounted or located in the air bag deployment area will damage or reduce the effectiveness of the air bag, or become a projectile that could cause serious personal injury. Refer to your vehicle owner manual for the air bag deployment area. The User/Installer assumes full responsibility to determine proper mounting location, based on providing ultimate safety to all passengers inside the vehicle.
- \*If mounting this product requires drilling holes, the installer must be sure that no vehicle components or other vital parts could be damaged by the drilling process. Check both sides of the mounting surface before drilling begins. Also de-burr any holes and remove any metal shards or remnants. Install grommets into all wire passage holes.
- \*Inspect and operate this product regularly to confirm its proper operation and mounting condition. Do not use a pressure washer to clean this product.
- \*For this product to operate at optimum efficiency, a good electrical connection to chassis ground must be made. The recommended procedure requires the product ground wire to be connected directly to the NEGATIVE (-) battery post.
- \*It is recommended that these instructions be stored in a safe place and referred to when performing maintenance and/or reinstallation of this product.
- \*FAILURE TO FOLLOW THESE SAFETY PRECAUTIONS AND INSTRUCTIONS COULD RESULT IN DAMAGE TO THE PRODUCT OR VEHICLE AND/OR SERIOUS INJURY TO YOU AND YOUR PASSENGERS!**
- If this product uses a remote device to activate or control this product, make sure that this control is located in an area that allows both the vehicle and the control to be operated safely in any driving condition.
- Do not attempt to activate or control this device in a hazardous driving situation.

### The K-700 & K900 Flash Pattern

- P1: Single 120 FPM Ph1-Color 1&2
- P2: Single 120 FPM Ph2-Color 1&2
- P3: Single 300 FPM Ph1-Color 1&2
- P4: Single 300 FPM Ph2-Color 1&2
- P5: Single 75 FPM Ph1-Color 1&2
- P6: Single 75 FPM Ph2-Color 1&2
- P7: Double 75 FPM Ph1-Color 1&2
- P8: Double 75 FPM Ph2-Color 1&2
- P9: Double 120 FPM Ph1-Color 1&2
- P10: Double 120 FPM Ph2-Color 1&2
- P11: Quad 75 FPM Ph1-Color 1&2
- P12: Quad 75 FPM Ph2-Color 1&2
- P13: Quad 120 FPM Ph1-Color 1&2
- P14: Quad 120 FPM Ph2-Color 1&2
- P15: Quint 120 FPM Ph1-Color 1&2
- P16: Quint 120 FPM Ph2-Color 1&2
- P17: 2 Double 75 FPM, 4 Quad 120 FPM
- P18: Modul. Flash Color 1<-->2
- P19: AutoRun
- P20: STEADY BURN

P1:SINGLE 120 Flash P1(Sync) is **Factory Default**.  
 Phase Operation: Ph1= Phase 1 / Ph2=Phase 2  
 Phase 1 (Ph1) flashes simultaneously with Ph1  
 Phase 2 (Ph2) flashes simultaneously with Ph2  
 Ph1 alternates with Ph2

**WIRE:**  
 RED: Positive (need to add 3A Fuse)  
 BLACK: Negative  
 BLUE: Pattern Switch  
 YELLOW: Synchronized Function  
 \*Maximum of 8 LHX series be synchronized

**OPERATION**  
**Apply BLUE TO BLACK wire:**  
 -Less than 1 sec. for next pattern  
 -between 1-3 sec. for previous pattern  
 -between 3-5 sec. for Factory Default(P1)  
 -more than 5 sec. to turn off and reset to P1

Specification	<b>K-700 &amp; K900</b>
Input Voltage	<b>10-30VDC</b>
Input Current	<b>2.5 Amps max</b>
Output Power	<b>New generation Led*6 / 12 (One Head)</b>
Waterproof	<b>IP67</b>

### Standard Mount

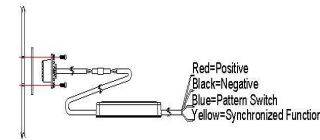

### Flange Mount

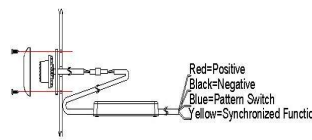

### L Bracket Mount

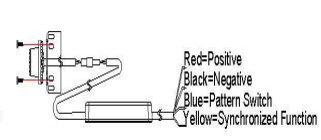

### Dimensions(inches)

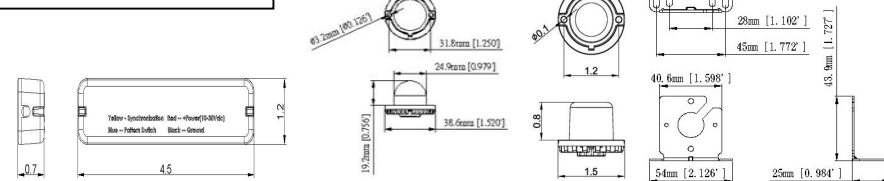

### L Bracket AND C Bracket

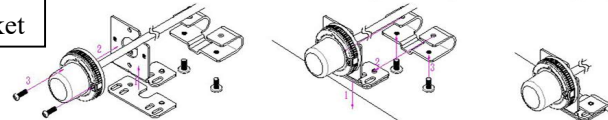

**Inspect the contents to be certain that the following items are included:**

A.ECU with Light Head B. Hards Kit C. Manual

### Recommend Operation Environment

**Ambient Temperature:** -30 to 50°C **Relative Humidity:** 10 to 85% non-condensing

### Trouble Shooting

- The Hide-A-Way series has been factory tested and approved. If the functions of the device fails, please check the followings:
1. After connecting with the power supply, be sure that the power source end is joined correctly. Then, make sure that there is no short-circuited power occurring.
  2. Ensure Power switch is turned to "ON" position.

### Warranty

This product was tested and found to be operational at the time of manufacture. Provided this product is installed and operated in accordance with the manufacturer's recommendations, STL guarantees the **Flare™** Series Light for a period of 3 years from the date of purchase. Units demonstrated to be defective within the warranty period will be replaced or repaired. Improper installation or use of inappropriate or inadequate wiring or circuit protection causes the warranty to be void. Failure or destruction of the product resulting from abuse or unusual use and/or accidents is not covered by this warranty. STL shall in no way be liable for other damages including consequential, indirect or special damages whether loss is due to negligence or breach of warranty. **STL MAKES NO OTHER EXPRESS OR IMPLIED WARRANTY INCLUDING, WITHOUT LIMITATION, WARRANTIES OF FITNESS OR MERCHANTABILITY, WITH RESPECT THIS PRODUCT.**